

Conteúdo da embalagem

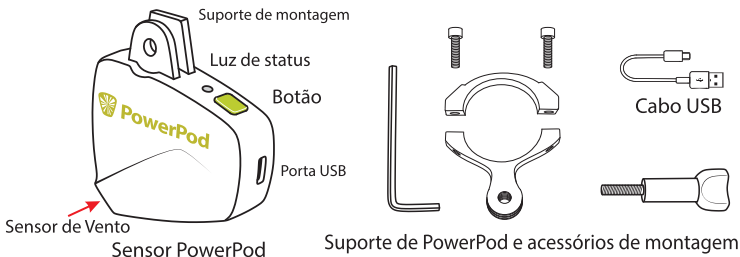

1. Carregue a bateria do PowerPod

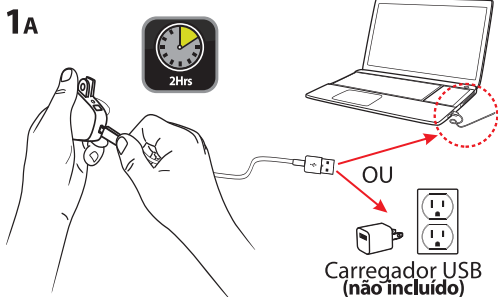

1B



1c

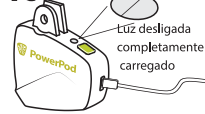

2. Fixe o suporte à bicicleta

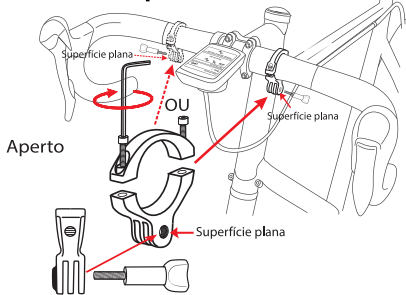

3. Prenda o PowerPod ao Suporte

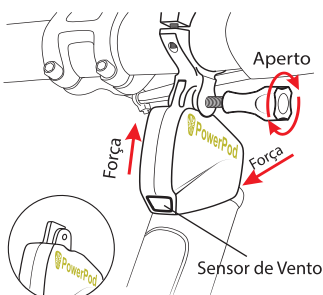

4. Emparelhe o PowerPod aos sensores ANT+ da bicicleta

4A

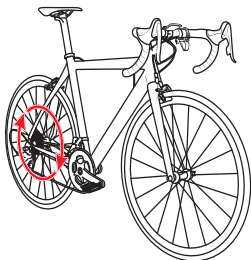

Gire a roda para ligar o sensor de velocidade

4B

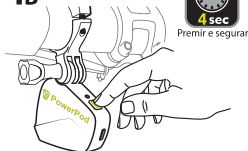

Pressione e segurar 4 segundos para emparelhar

4C

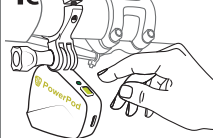

Solte o botão
Quando a luz verde piscar

4D



Emparelhamento bem sucedido
luz verde continua

4E



VERMELHO: emparelhamento malsucedido

5. Emparelhamento do Powerpod com o CicloComputador ANT+

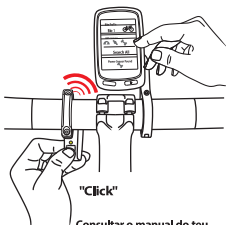

Consultar o manual do teu CicloComputador sobre instruções de emparelhamento

6. Calibrar

6A

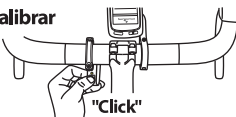

Luz amarela - preparado para a calibração

6B



Ande na bicicleta durante 5 min.

Luz amarela a piscar durante a calibração

6C

Durante a calibração, a potência aumenta de 1 a 100

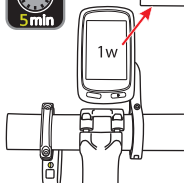

Após 5 minutos, a potência real é mostrada

7. Depois da Calibração

7A

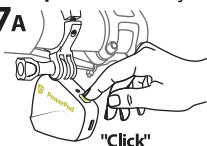

Luz verde a piscar

7B

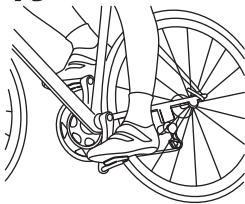

Gira a roda, luz verde continua

7C

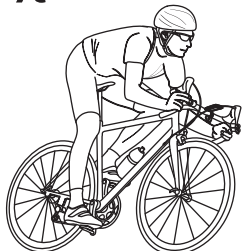

VERDE, PODE SEGUIR!